

DEMOLITION PLAN

1/8"=1'-0"

COORDINATION:

A. Changes affecting the layout shown must be specific and clearly conveyed to GreenWorks Engineering and Consulting in written form as a change for inclusion into these plans. Contractor and/or client shall verify all dimensions and layout prior to construction. All dimensions on structural drawings shall be checked against architectural drawings and any discrepancies shall be brought to the attention of the Architect and Engineer immediately.

B. These construction documents were prepared with information about the existing building provided from field measurements of the as-built building taken by personnel of GreenWorks Engineering and Consulting on April 10, 2020 and April 15, 2020. If the contractor discovers existing conditions which vary from those shown on these documents he shall notify GreenWorks Engineering and Consulting immediately for guidance on necessary changes to be made.

C. All temporary shoring shall be the responsibility of the contractor.

D. Design is void after two years from original date of issue, unless updated to acceptable codes and practices at that time.

E. Provide Smoke Alarms – hard wired, interconnected, battery backup, at each sleeping room and immediate common area outside of sleeping rooms, and located at not less than 3 ft. from a door to a bathroom with tub or shower except when this requirement will prevent the installation of a smoke alarm in a required location, AND if applicable, on each additional story including basements and habitable attics. Note: Interconnection of smoke alarms in existing areas shall not be required where alterations/repairs do not result in removal of interior wall or ceiling finishes exposing the structure.

F. Provide Carbon Monoxide Alarm – hard wired with battery backup, installed outside of each separate sleeping area in the immediate vicinity of the bedrooms in dwelling units within which fuel-fired appliances are installed and/or have an attached garage.



Wayne Leake III

04/20/2020

EXISTING PLAN

Project No: 18696
Date: 04/20/2020

Revision Date:

S1

OF: 2

GREENWORKS
ENGINEERING & CONSULTING
Texas Eng. Firm : 20170
600 N. Pearl Street
Suite S1900
Dallas, Texas 75201
(855) 349-6757

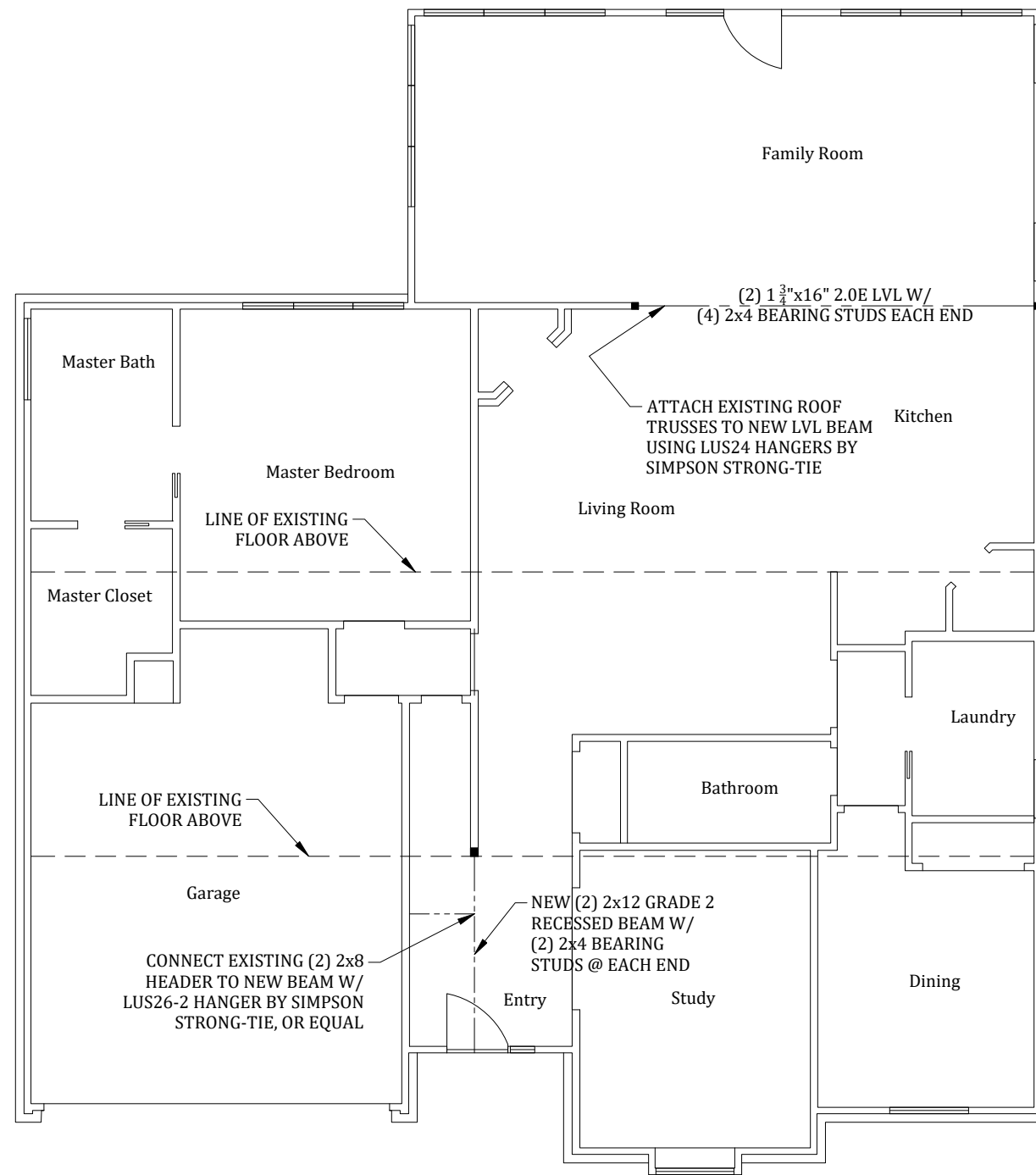

LOADING: (IRC 2015)	
ROOF DEAD	10 psf
ROOF LIVE	20 psf
ROOF SNOW	5 psf
CEILING DEAD	5 psf
CEILING LIVE	10 psf
FLOOR DEAD	10 psf
FLOOR LIVE	40 psf
WIND	115 mph
EXPOSURE	C
RISK CAT	II

FRAMING PLAN

1/8" = 1'-0"



Wayne Leake III

04/20/2020

FRAMING PLAN

Project No: 18696
Date: 04/20/2020

Revision Date:

S2

OF: 2