

COORDINATION:

A. Changes affecting the layout shown must be specific and clearly conveyed to GreenWorks Engineering and Consulting in written form as a change for inclusion into these plans. Contractor and/or client shall verify all dimensions and layout prior to construction. All dimensions on structural drawings shall be checked against architectural drawings and exact field conditions and any discrepancies shall be brought to the attention of the Architect and Engineer immediately.

B. These construction documents were prepared with information about the existing building provided from field measurements of the as-built building taken by personnel of GreenWorks Engineering and Consulting on March 13, 2020, and April 9, 2020. If the contractor discovers existing conditions which vary from those shown on these documents he shall notify GreenWorks Engineering and Consulting immediately for guidance on necessary changes to be made.

C. All temporary shoring shall be the responsibility of the contractor.

D. Design is void after two years from original date of issue, unless updated to acceptable codes and practices at that time.

E. Provide Smoke Alarms – hard wired, interconnected, battery backup, at each sleeping room and immediate common area outside of sleeping rooms, and located at not less than 3 ft. from a door to a bathroom with tub or shower except when this requirement will prevent the installation of a smoke alarm in a required location, AND if applicable, on each additional story including basements and habitable attics. Note: Interconnection of smoke alarms in existing areas shall not be required where alterations/repairs do not result in removal of interior wall or ceiling finishes exposing the structure.

F. Provide Carbon Monoxide Alarm – hard wired with battery backup, installed outside of each separate sleeping area in the immediate vicinity of the bedrooms in dwelling units within which fuel-fired appliances are installed and/or have an attached garage.

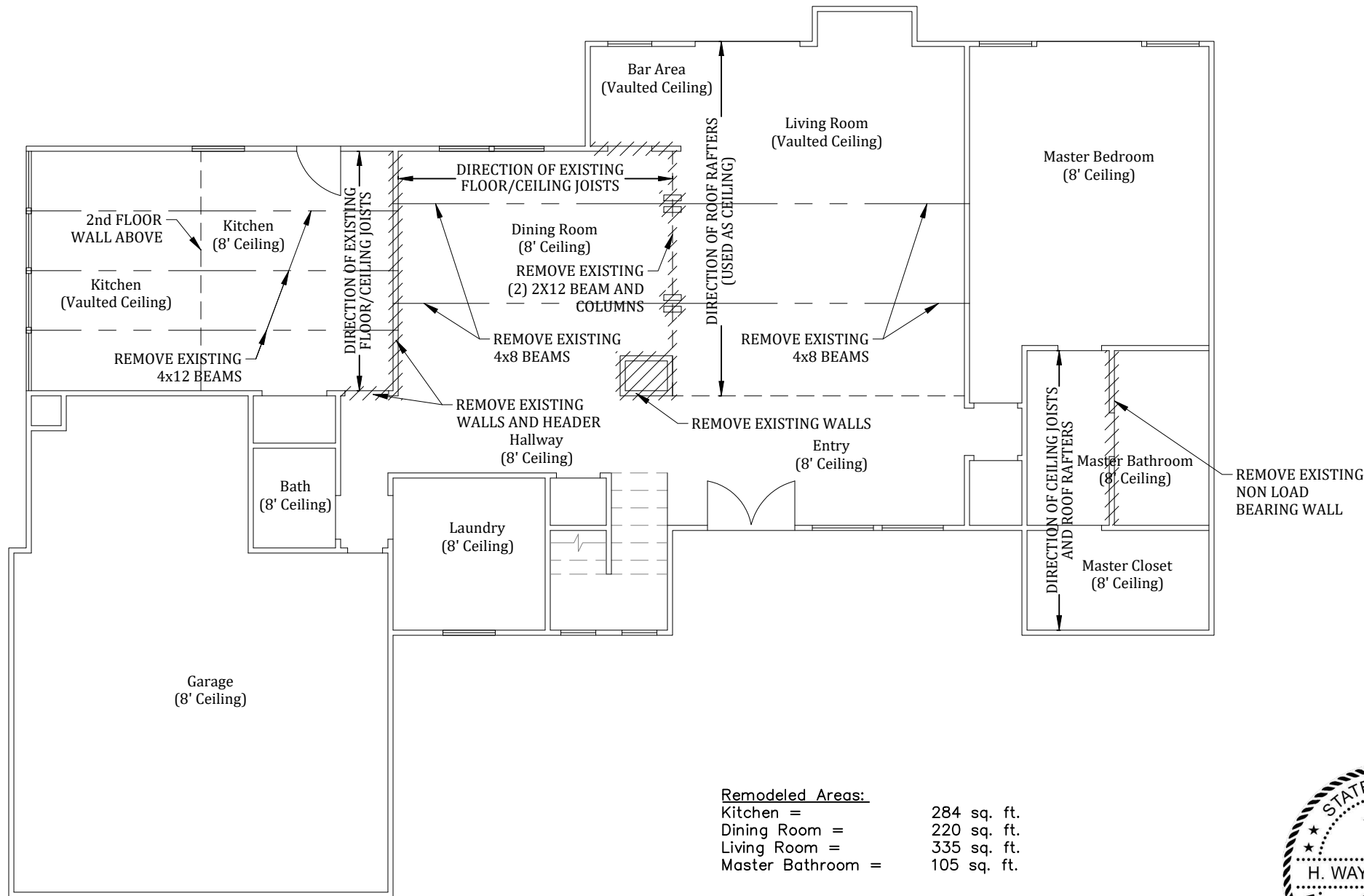

DEMOLITION PLAN

1/8"=1'-0"



Wayne Leake III

05/01/2020

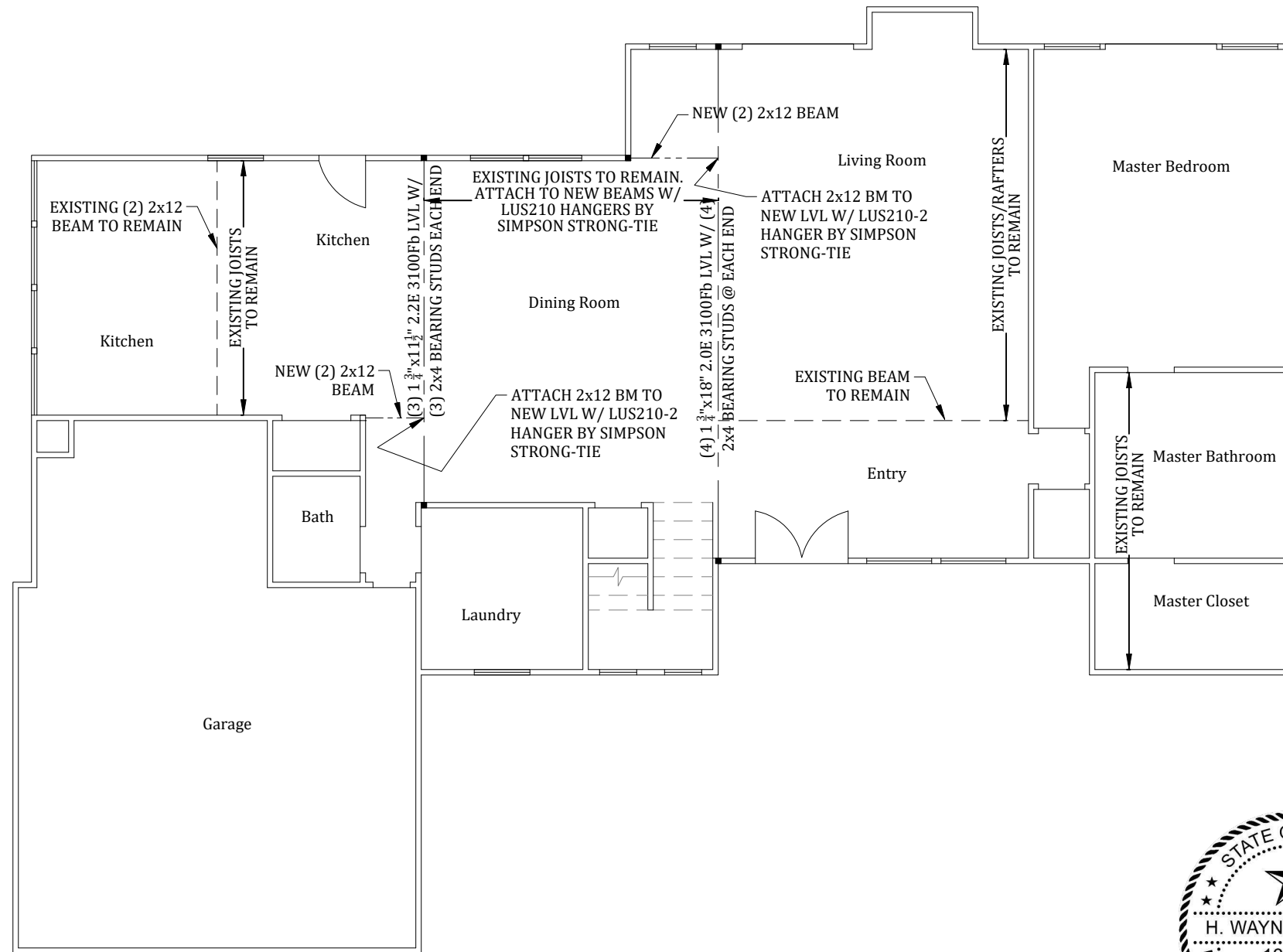

LOADING: (IRC 2015)

ROOF DEAD 10 psf
 ROOF LIVE 20 psf
 ROOF SNOW 5 psf

FLOOR DEAD 10 psf
 FLOOR LIVE 30 psf

WIND 115 mph
 EXPOSURE C
 RISK CAT II

FRAMING PLAN

1/8" = 1'-0"



Wayne Leake III

05/01/2020

FRAMING PLAN

Project No: 17817
 Date: 04/09/2020

Revision Date:
 05/01/2020

S2

OF: 2

GREENWORKS
 ENGINEERING & CONSULTING

600 N. Pearl Street
 Suite S1900
 Dallas, Texas 75201
 (855) 349-6757

Texas Eng. Firm : 20170